



Beach Towers' Gardening Manual 2011-2012

Written & Compiled by:
Dana Petric
Technical Writing & Web Design

Table of Contents

Introduction.....	4
Purchasing.....	5
Plants.....	5
Supplies.....	5
Garden Tools and Equipment	6
Spring Tasks.....	7
March	7
April	7
May	8
Summer Tasks.....	9
June	9
July.....	9
August.....	10
Fall Tasks	11
September	11
October.....	11
November.....	12
Winter Tasks	13
December	13
January	14
February	14
Collecting Garbage and Weeding Grass (Dandelions).....	16
Perennial Tasks	17
Dividing Perennials.....	17
Feeding Perennials	17
Planting Fall Bulbs.....	19
Trimming Perennials.....	19
Deadheading Perennials.....	21
Wintering Perennials.....	21
Lawn Care.....	22
Aerating.....	22
Edging (Sidewalk)	22
Edging (Beds)	22
Fertilizing.....	22
Liming.....	23
Mowing.....	23
Weed-Eating	24
Weeding	25
Rose Care	26
Feeding Roses	26
Spraying Roses for Aphids	26
Pruning Roses	26
Pruning Dormant Roses	27
Spraying Roses with Dormant Oil	27

Composting Leaves..... 28

Shaping Hedges, Shrubs, Small Trees 28

 3 Types of Shaping 28

 Shaping Hedges 28

 Shaping Shrubs 29

 Shaping Small Trees 29

 Starting Gas Powered Trimmer 29

Checklist for Sub-Contractors..... 30

Plant Reference Guide 31

 List of Perennials 31

 List of Annuals..... 40

 List of Conifers 43

 List of Trees and Bushes..... 43

 List of Perennial Spring Bulbs 44

Watering Procedures..... 45

 P3, Oval 14, Mac 1, 2, & 3, Round Planters 1 & 2, Laurier Planters 45

Introduction

This gardening manual provides an overview of seasonal tasks and daily duties for the maintenance of the Gardens at Beach Towers.

The Beach Towers' apartment complex consists of 4-21 story buildings. The gardens have 33 flower beds, 35 raised planters (with shrubs & trees) and an acre of lawn.

This manual also includes a plant reference guide.

Purchasing

Beach Towers requires a detailed description of plants purchased.

Here are some purchasing tips to follow:

- No funds provided in advance for purchasing
- Apply for a business VISA card and collect air points
- Purchase at the end of month for quick reimbursement of funds

Plants

Plant Purchasing Resources

Home Depot (HD) is a good plant resource. It receives plants from the large nurseries in Richmond, which alleviates the need to drive to Richmond or to pay for delivery charges.

Go once a week to HD and note the following:

- o Things that don't sell are offered at discount rates
 - o New plant shipments arrive on Tuesday & Fri (am)
- Note:** Attach receipts to invoice at end of month

Garden City Nurseries provides annuals only. At Garden City Nurseries, order the following:

- o Pansies
- o Begonias
- o Geraniums

TSC Nurseries supplies specialty plants, but it may replace Garden City Nurseries, as an annual supplier, when it closes.

Supplies

Purchase the following grass care supplies as needed:

- Gasoline (for mower, weed eater & edger)
 - o buy from gas station and only as much as needed (gas lasts only up to 2 month)
- Note: do not use old gas as it may ruin machines**
- Blades (for edger)
 - Wire (orange thickness for weed eater)
 - Fertilizer, lime, grass seed

Purchase the following plant care supplies as needed:

- Various plant foods, aphid spray, rose dormant oil
- Soil amender

Garden Tools and Equipment

Beach Towers does not reimburse funds for any gardening tools or equipment.

Purchase the following gardening equipment as needed:

- Shovels, rakes, gloves
- Lobbers and trimmers
- Rolling bins
- Weed baskets

Spring Tasks

The main spring gardening objectives are to do the following:

- ↳ Feed perennials
- ↳ Mow lawn
- ↳ Rake cherry blossoms from sidewalks
- ↳ Divide perennials
- ↳ Weed, as necessary

March

Collecting Garbage & Weeding Grass

See page 16.

Cleaning Plant Beds

Check beds 1 – 33 for weeds. Clean as necessary.

Dividing Perennials

See page 17.

Feeding Perennials

See page 17.

Mowing Lawn

See page 23.

April

Collecting Garbage & Weeding Grass

See page 16.

Cleaning Plant Beds

Check beds 1 – 33 for weeds. Clean as necessary.

Feeding Perennials

See page 17.

Mowing Lawn

See page 23.

May

Collecting Garbage & Weeding Grass

See page 16.

Cleaning Plant Beds

Check beds 1 – 33 for weeds. Clean as necessary.

Feeding Perennials

See page 17.

Mowing Lawn

See page 23.

Summer Tasks

The main summer gardening objectives are to do the following:

- ↳ Mow lawn
- ↳ Deadhead wilted blooms
- ↳ Water, as necessary
- ↳ Weed, as necessary

June

Collecting Garbage & Weeding Grass

See page 16.

Cleaning Plant Beds

Check beds 1 – 33 for weeds. Clean as necessary.

Deadheading Perennials

See page 21.

Mowing Lawn

See page 23.

July

Collecting Garbage & Weeding Grass

See page 16.

Cleaning Plant Beds

Check beds 1 – 33 for weeds. Clean as necessary.

Deadheading Perennials

See page 21.

Mowing Lawn

See page 23.

August

Collecting Garbage & Weeding Grass

See page 16.

Cleaning Plant Beds

Check beds 1 – 33 for weeds. Clean as necessary.

Deadheading Perennials

See page 21.

Mowing Lawn

See page 23.

Watering

See page 45.

Fall Tasks

The main fall gardening objectives are to do the following:

- ↳ Clean beds
- ↳ Deadhead and remove wilted blooms
- ↳ Plant fall annuals
- ↳ Rake leaves and pine needles
- ↳ Mow lawn
- ↳ Trim and divide perennials

September

Collecting Garbage & Weeding Grass

See page 16.

Cleaning Beds of Summer Annuals

- Clean beds as flowers fade.
- Weed as necessary.

Planting Fall Annuals & Perennials

- Plant pansies.
- Plant mums and asters.

Shaping Hedges, Plants, Bushes

- Trim tall cedar hedge on Beach Avenue. Break into 3 sections – 2 hours per section.
- Trim blackberry bushes at Columbus driveway.

October

Collecting Garbage & Weeding Grass

See page 16.

Planting Fall Annuals & Perennials

- Plant pansies and tulip bulbs.
- Plant perennials.

Shaping Hedges, Plants, Bushes

- Continue Cedar hedge trim on Beach Avenue.

Trimming Perennials

See page 19.

November

Collecting Garbage & Weeding Grass

See page 16.

Cleaning Plant Beds

1. Check beds 1 – 33 for weeds, leaves, and pine needles. Clean as necessary.

Dividing Perennials

See page 17.

Forking Beds

1. Using cultivating fork, move around soil to remove any small green weed specks in beds 4, 5, 6, 8, 9, 10, 10a.

Raking Leaves and Pine Needles

1. Rake leaves along Harwood, Cardero & Bidwell.
2. Rake pine needles in front of pine bed 15.
3. Dump in trenches behind Douglas, Columbus (bed 31 & 33) and Laurier (bed 2).

Shaping Hedges

- Continue Cedar hedge shaping on Beach Avenue.

Trimming Perennials

See page 19.

Winter Tasks

The main winter gardening objectives are to do the following:

- ↳ Deadhead and remove wilted blooms
- ↳ Weed
- ↳ Divide plants
- ↳ Water P3 covered planters
- ↳ Turn compost leaves
- ↳ Trim blackberries

December

Collecting Garbage & Weeding Grass

See page 16.

Cleaning Plant Beds

1. Check beds 1 – 33 for weeds, leaves, and pine needles. Clean as necessary.

Deadheading Pansies

1. Check beds 1, 4, 5, 10, 20 for drooping pansies. Deadhead as necessary.
2. Check beds 4, 5, 6 for dry dianthus buds. Deadhead as necessary.

Edging (Beds)

1. Using half-moon edger shovel, edge at beds 1 & 20. Continue to beds 12, 21, 22 & 23.

Forking Beds

1. Using cultivating fork, move around soil to remove any small green weed specks in beds 4, 5, 6, 8, 9, 10, 10a.

Watering

P3 Planters

1. Check Jasmine in P3 planters for dryness. Water jasmine once a week.
2. Water all other planters twice a month.

Mac 1, 2, 3 & Laurier Planters

1. Check Mac 1, 2 & 3 planters. Water as necessary.

2. Check Laurier Planters. Water as necessary.

Spraying Dormant Oil on Roses

Prep: Mix part 1 & 2 of oil in the sprayer.

1. Spray roses in beds 10a, 11, 17, 24 and P3 planters (F, G, H, J, K, L, N, O).

January

Collecting Garbage & Weeding Grass

See page 16.

Deadheading Pansies

1. Check beds 1, 4, 5, 10, 20 for drooping pansies. Deadhead as necessary.
2. Check beds 4, 5, 6 for dry dianthus buds. Deadhead as necessary.

Forking Beds

1. Using cultivating fork, move around soil to remove any small green weed specks in beds 4, 5, 6, 8, 9, 10, 10a.

Watering

P3 Planters

1. Check Jasmine in P3 planters for dryness. Water jasmine once a week.
2. Water other planters twice a month.

Mac 1, 2, 3 & Laurier Planters

1. Check Mac 1, 2 & 3 planters. Water as necessary.
2. Check Laurier Planters. Water as necessary.

February

Collecting Garbage & Weeding Grass

See page 16.

Deadheading Pansies

1. Check beds 1, 4, 5, 10, 20 for drooping pansies. Deadhead as necessary.
2. Check beds 4, 5, 6 for dry dianthus buds. Deadhead as necessary.

Forking Beds

1. Using cultivating fork, move around soil to remove any small green weed specks in beds 4, 5, 6, 8, 9, 10, 10a.

Watering

P3 Planters

1. Check Jasmine in P3 planters for dryness. Water jasmine once a week.
2. Water other planters twice a month.

Mac 1, 2, 3 & Laurier Planters

1. Check Mac 1, 2 & 3 planters. Water as necessary.
2. Check Laurier Planters. Water as necessary.

Collecting Garbage and Weeding Grass (Dandelions)

The garbage walk around is a good time to get an overview of the current condition of the gardens, and of course, to pick up garbage. Follow the dotted lines for route.

Scan property for urgent jobs such as wind damage or uprooted plants.

Follow dotted lines for Garbage Route:

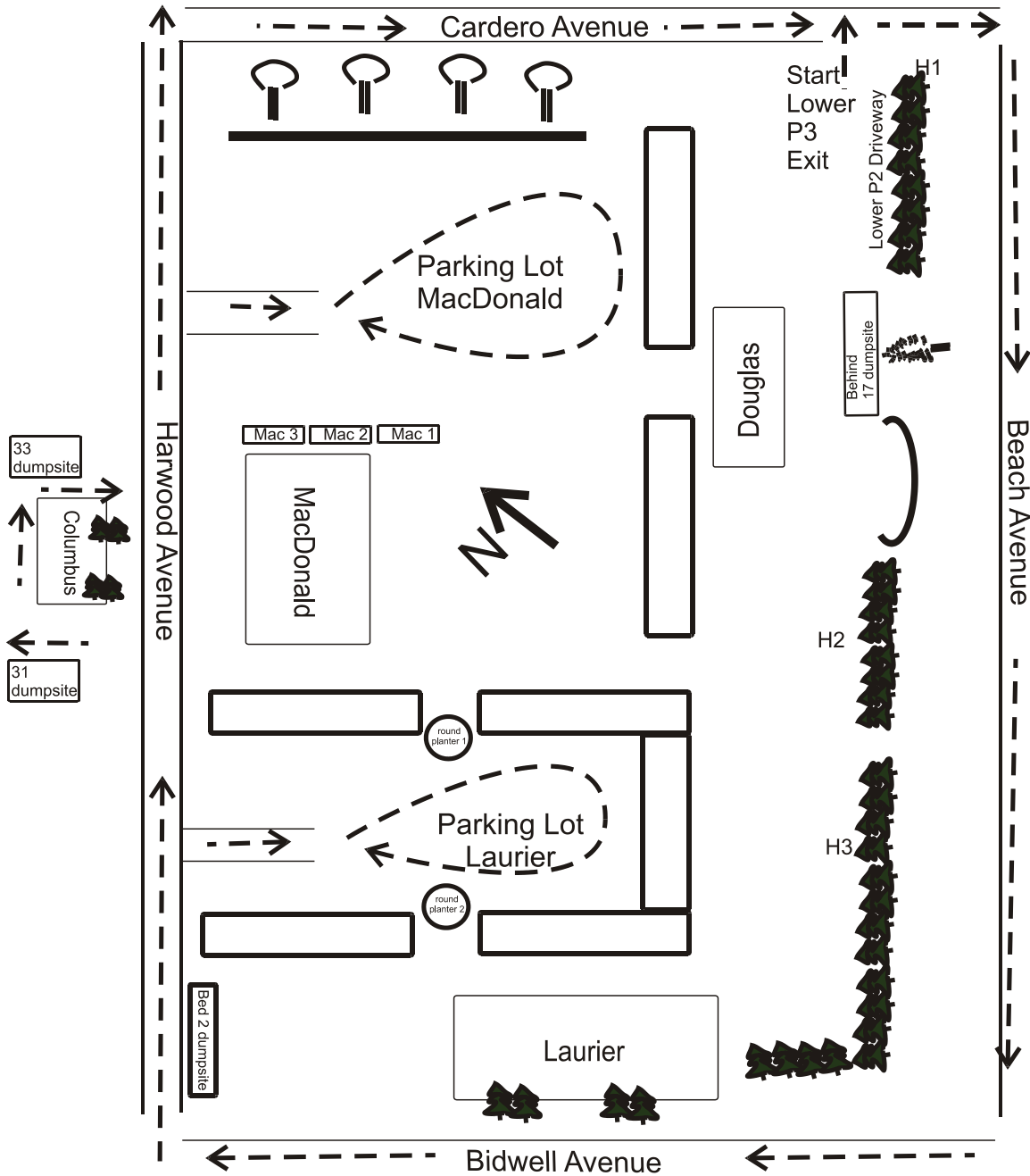

Weed for dandelions, buttercups and flat round-leaved plantains. Each weeding session should last for at least 15 minutes.

Perennial Tasks

Dividing Perennials

Perennial	Location	Dividing Procedure	Timing
Crocoshmia	P3, 23, 26, 29	Dig up and divide every 3-4 years	Mid-November
Hosta	P3, 23	Dig up and divide every 3-4 years (Before shoots sprout)	Early to mid-November or early Spring
Iris	4, 5, 6, P3 planters A, C, D (confirm others)	Dig up old rhizome, break apart keeping root base intact	Mid-fall
Ligularia	12, 14	Dig up and divide every 3-4 years	Spring or fall?
Primula	Throughout	Dig up and divide every 3-4 years	Mid-fall
Sarcococca	Throughout	Break apart w/shovel as needed	After April

Feeding Perennials

Feeding – early Spring and mid-Fall.

Supplies	Quantity	Dose	Feeding Technique
Rhodo, Azalea & Camellia food [4-12-8] (RAC)	3 ½ to 4 boxes of food	2 tsp for 12"x12" area (approx size of dime) Spread 1-3" into soil and work in well	
Miracle Grow Slow Release (MGSR) 10-10-10	2 bags	Small plant – 3 tbsp Med plant – 6 tbsp Large plant – 10 tbsp	Stand above plant and pour over top. Avoid direct contact with stem.

Type	Location	Size of Perennial	Food/Amt	Frequency
Amelanchier Canadensis (spice berry)	26	Medium-large	Miracle Grow Slow Release (MGSR)	Spring
Astilbe	12	Small-med	MGSR	Spring
Azaleas	P3 planters B, C, D, E, I, K	Medium	Azalea & Rhodo Food	Early March & late June
Begenia	12, 14	Small	MGSR	Spring
Euphorbia	6	Medium	MGSR	Spring
Flax	3, 4, 5, 6, 9, 10	Medium	MGSR	Spring
Gay feather	12, 16, 17, 18, 19	Sm-med	MGSR	Spring
Heather	All areas	Medium	MGSR	Spring
Heavenly bamboo	2	Medium	MGSR	Spring
Hebe	1, 11, 13, 20, 26	Small	MGSR	Spring
Hellebore	8	Small	MGSR	Spring
Heuchera	1, 8, 26	Small	MGSR	Spring
Hosta	23	Small	MGSR	Spring
Japanese Anemone	3, 4, P3, 10a, 12	Medium	MGSR	Spring
Jasmine	Planters a, e, f, g, k, o	Medium	MGSR	Early spring
Lavender	5, 9, 10, 17, 20	Medium	MGSR	Spring
Ligularia	12, 14	4' Medium	Fertilizer (5-10-5)	Spring & early summer
Lilac	14, 32	Medium	MGSR	Spring

Magnolia (Grande Flora)	24, 32, behind Columbus	Large	MGSR	Spring
Mock orange	8, 10, 23, 26	Medium- Large	MGSR	Spring
Pieris	3, 4, 6, 8, 9, 10, 11, 12, 21, 22, 23	Med-large	MGSR	Spring
Rhododendron	1, 4, 5, 6, 9, 10, 13	Medium- Large	Azalea & Rhodo Food	Spring
Sedum	14, P3	Small	MGSR	April & June
Snapdragon (feed only thriving plants)	All areas	Small	Azalea & Rhodo Food	Spring
Willow (Japanese)	5, 10a	Med-large	MGSR	Spring

Planting Fall Bulbs

Name of Flower	Location	Blooms	Date Planted
Tulip	Douglas P, Q, R) 4, 5, 15,	Spring	w/o October 24, 2011
Hyacinth	11	Mid-Spring	w/o October 24, 2011
Allium	24, 25	Mid-spring & summer	w/o October 24, 2011

Trimming Perennials

Rule for Trimming: once new growth starts, and chance of frost is gone, trim at new growth.

Perennial	Location	Trimming Procedure	Timing
Buddleia (butterfly bush summer lilac)	10, 12	Trim aggressively	Twice a year (after blooming)
Camelia	Bed 23	Over a 3-year period (after it flowers) until size reduced without destroying natural shape.	After bloom

Perennial	Location	Trimming Procedure	Timing
Chrysanthemum	bed 5 between chimneys	Wait for plants to reach height of 1 foot. Trim to 6". After blooming, leave till chance of frost is over, then cut down to 3".	Twice a year (mid-spring & late summer)
Daisies	4, 5, 11, 12	Cut to 3" height	After blooming (late fall)
Hebe	11 & Laurier Boxes	Trim off 3" from tips.	Mid-spring
Hosta	8, 12, Planters N, O	Wait for leaves to yellow and wilt. Trim down to 3".	Early to mid- November
Hydrangeas	12	Cut stems back to a pair of fat healthy buds in early March. Remove weak spindly stems to improve shape.	Late winter
Japanese Anemones	4, 5, Planters	Cut to 3 inch height.	After blooming (early winter)
Junipers	4,5,6	Cut back to new growth (not into old hard wood)	Fall
Lavender	5, 6, 9, 10, 20	Cut back from base to expose main stem. Then, trim off new growth and dried flowers – about 1/3 of plant	After blooming before the rain arrives (September)
Lilac (Korean Dwarf)	Oval 14	Trim down 25% to create a tight ball.	After bloom (late spring)
Lilac (California)	5, Douglas Planter Q	Shape like a hedge in bed 5. Trim bottom branches to create a standard stem in Douglas Planter.	Mid-summer (after blooming)
Ligularia	12, 14	Trim dead/dry leaves to ground. Trim off dead blooms. After final blooms, cut down to 5".	Spring to fall
Peony	21, 26	Cut down to 3 inches	Late fall
Pieris	Various beds	Trim around base	As needed
Rhododendron	1, 4,5, 6, 9, 10, 24	Over a 3-year period (after it flowers) until size reduced without destroying natural shape	
Snapdragons	5, 8, 21, 25	Trim tops off large plants. Cut others to 3 inch height.	After blooming (early winter)
Winter Laurel	12	Trim excess growth.	Late fall.
Wormwood	12	Trim in Spring to 1-2" after first year Trim up to ½ when plant becomes	Spring As necessary

Perennial	Location	Trimming Procedure	Timing
		unruly	

Deadheading Perennials

Plant	Deadheading Procedure	Timing
Begonias	Remove dry flowers	Summer/fall
Daisies (Shasta)	Trim down when flowers are dry.	Late spring/summer/ fall
Dianthus	Remove shriveled blooms. Use clipper to deadhead on mass in bed 5.	Late spring/summer/ fall
Geraniums	Deadhead shriveled or soggy blooms.	Late spring/summer/ fall
Irises	Wait till long stocks are dry. Remove yellowed leaves.	Late spring/summer/ fall
Pansies	Deadhead shriveled flowers. Remove stringy stems.	Late spring/summer/ fall and winter
Snapdragons	Remove shriveled blooms. Trim down to 3 inches when blooms done for season.	Late spring/summer/ fall

Wintering Perennials

Plant	Location	Wintering Procedure	Timing
Flax	5, 6, 9, 10, 11	Make tent-like structure with cedar bows over flax plants.	Late November
Snapdragons	8, 12, 15, 21, 24	Add 1 cup sawdust to base of snapdragon.	Late November
Primulas	5 (beside chimney)	Place any small primulas in this location – works well as a incubator. Once they are twice the size, separate and plant in other areas.	Late January to early February

Lawn Care

Aerating

Time: 3+ hours
Frequency: once in late winter (on a dry day)
Equipment: Aerator (rent from Home Depot)

Prep

- Follow rental instructions.

Aerating

Route: Start aerating at Bidwell & Beach. Aerate along Harwood, then Cardero and finally Beach Avenue.

Edging (Sidewalk)

Time: 1 hour
Frequency: every 6 weeks (dry windy day)
Equipment: Edger

Prep

- Set edging blade to 1-2" below grade.

Note: edging blade lasts for 3-4 trips around the property.

Edging

Route: Start edging at Bidwell & Beach. Edge your way along Harwood, then Cardero and finally Beach Avenue.

Edging (Beds)

Time: 1 hour
Frequency: every 4 weeks
Equipment: Half-moon edger shovel

Edging

Beds: Beds 1, 12, 20, 21, 22, 23

Fertilizing

When: Early spring (while grass dormant)
Conditions: Dry weather with rain pending??

Equipment: Scott Spreader
Fertilizer: Corn Weed and Feed: 4 – 20 lb bags to cover entire property

When: Mid-summer
Conditions: Dry weather with rain pending??
Equipment: Scott Spreader
Fertilizer: Scott's Summer Feed: 2 – 20 lb bags to cover entire property

When: Late fall
Conditions: Dry weather with rain pending??
Equipment: Scott Spreader
Fertilizer: Scott's Winter Feed: 1 ½ – 20 lb bags to cover entire property

Liming

When: Early fall (October) and late spring (April)
Conditions: Dry weather with rain pending
Equipment: Scott Spreader
Lime: Dolopril (3 - 50 lb. bags to cover entire property)

Mowing

Time: 3 hours
Frequency: every 2 weeks in spring/fall, once a week in mid-summer
Equipment: mower, garbage can, small broom & dust pan

Prep

1. From “**Gas**” cupboard, take “**Mower**” container and fill mower’s gas tank.
2. Unscrew black ring. Remove “yellow” cap and place beside mower.
3. Pull out long yellow spout and insert in black ring.
4. Screw black ring with yellow spout on gas can opening.
5. Bend long yellow spout into gas can opening and pour slowly until liquid reaches top.
6. Leave the gas can on the table for re-filling later.

Starting Cold Mower

1. Compress handle and pull chord until fully extended. Release chord slowly.

****Raise or lower wheels as needed- Watch for Rocks and Roots!****

Mowing Technique

↵ *Begin mow on Columbus lawn – easier to lift mower up the stairs at beginning of mow*

- ↵ *Mow each lawn segment (clockwise) one extra pass, to check for missed spots.*
- ↵ *Drive tight (counter-clockwise) around obstacles.*
- ↵ *Watch for tree roots, rocks and debris!!*

1. Start mowing behind Columbus House. Leave garbage can out front.
2. Mulch grass or spread clippings behind Beds 31 or 33.
3. Once Columbus mow is complete, sweep away grass clippings left on stairs or patio area.
4. On mower, **lower wheels 1 notch**. Harwood, Laurier and Cardero lawn requires a closer mow.
5. Cross the street and start mowing property clockwise from front at Laurier. Bring garbage can with you.
6. Refill gas at P3 driveway, before mowing Beach Avenue.
7. Once mowing is complete, spread clippings beneath overhang behind bed 17.

Weed-Eating

Prep

- Time:** 1 hour
Frequency: once a month spring to fall
Route: Start on Cardero and proceed clockwise around property.

1. From “**Weed Eater**” container in gas cupboard, fill weed eater with gas.

Starting Cold Weed-Eater

1. Place weed-eater on ground, and compress primer 3 times.
2. Press “**on**”. Flip **choke** to blocked position.
3. As you pull chord, compress accelerator grip. Release chord immediately and let idle.
4. Ease off choke as engine warms.

Note: Release more winding as needed by compressing bottom nipple on grass while spinning.

Weeding

Equipment: manual stick weeder

Route: Start weeding at Beach Avenue to Bidwell. Continue along Harwood. Main weed focus is 4 corners of property and building entrances. (see **page 16 - Garbage Route map**)

- ↵ Remove dandelions and buttercups from lawn during garbage collection.
- ↵ Spend at least 15 minutes per weeding session.

Rose Care

Feeding Roses

Supplies: 3 buckets of Pink All Purpose Garden Fertilizer (8-12-6)

Location	Size of Rose	Amount	Frequency
Bed 9 (triangle) Beds 11, 12 Beds 16 & 17 Bed 24 (Columbus)	Medium-large (tea roses)	175 ml x 2 (sprinkle 6" from trunk & blend with soil)	Every 3 weeks (starting from April 1 – July 21)
Bed 4 (between chimneys)	Medium (Bush roses)	250 ml	Every 3 weeks (starting from April)
Planter G, L, M, N, O (on P3)	Small (bush roses)	175 ml	Every 3 weeks (starting from April)

Spraying Roses for Aphids

Start pre-emptive spraying on new growth before aphids appear.

Supplies: Green Earth Insecticidal Soap (see bottle for water/soap ratio)

Equipment: Large sprayer

Check for aphids (light green or black spots) when bud or new leaf growth begins to appear on roses. Aphids attack the buds. Spray as often as necessary.

Pruning Roses

During summer growth, regular trimming of roses is necessary.

Type	Location	Technique	Time
Rose (Tea)	Bed 24, 31	Trim dead bloom above a 5-leaf branch.	As needed
Rose (floribunda)	9a, 11	Trim dead bloom above a 5-leaf branch.	As needed
Bush Rose	5, 6, P3 Planters: F, G, J, K, L, N, O	Trim extra growth and shape bush into a ball form.	Late spring
Tree Rose	11	Trim extra growth and shape into a ball form.	As needed

Pruning Dormant Roses

Once leaves drop, plant is dormant (early December).

Type	Location	Technique	Time
Rose (Tea)	Bed 24	Trim to 3'.	Early December
Rose (floribunda)	9a	Trim to 1'.	Early December
Bush Rose	5, 6, P3 Planters: F, G, J, K, L, N, O	Trim to 18".	Early December
Tree Rose	11	Trim extra growth and shape into a ball form.	Early December

Spraying Roses with Dormant Oil

Once roses pruned, spray with dormant oil.

Supplies: Dormant Oil (2 parts)

Equipment: Large sprayer

Composting Leaves

Dump leaves in designated composting sites. (see page 16).

Once all leaves are collected, cover with soil. Turn leaves periodically during winter months.

Add composted soil to beds as necessary.

Shaping Hedges, Shrubs, Small Trees

3 Types of Shaping

- Above head up to 8" using gas-power trimmer
- Above 8' using pruning ladder and loppers or Swedish saw.
- Extended, using electric trimmer attached to pole extension for extra thick hedges on south side of P3 patio.

Hedges

Time: 3-4 hours per shaping session
Frequency: Twice a month from July-November
Equipment: Gas powered trimmer or electric trimmer (as necessary)

Shrubs

Time: 1 hour per shaping session
Frequency: Once a month from July-November
Equipment: Gas powered trimmer or manual shears

Small Trees

Time: 1 hour per shaping session
Frequency: Once a month from January-December
Equipment: Loppers or Swedish saw

Shaping Hedges

Equipment: Gas-powered hedge trimmer (large hedges)
Rake, bin

After planting is over and weeds are under control, begin shaping in mid-June. The goal is to end shaping by September. See map page 16 for locations of hedges.

1. Begin shaping hedges in front of Laurier and Columbus.
2. Continue with hedge "trees" on Cardero.
3. Go to Beach & Cardero. Start shaping at H1.

4. With weather and time permitting, continue shaping H2 and H3.

Shaping Shrubs

The shrubs at Beach Towers are winter laurels, paracanthas and lavender (herb).

5. Using hand shears, shape winter laurels in beds 7, 8, 11, 12 & 14.
6. Using hand shears, shape paracanthas in bed 11.
7. Using hand shears, shape lavender in beds 5, 6, 9, 10, 14, and 20. (see page 19)
8. Behind Columbus where needed.

Shaping Small Trees

The small trees at Beach Towers are Budleia??

1. Using loppers, go to beds 10 and 12 and shape Budleias.

Prep for Gas Powered Trimmer

- 50:1 ratio=Mix 2.6 oz of 2-cycle lubricant with 1 gallon of fresh gasoline in separate gas container. Shake. Pour into fuel tank.

Starting Gas Powered Trimmer

Note: Do not squeeze throttle trigger until engine starts and runs.

1. Place trimmer on flat, bare surface.



2. **Prime** press  7 times.

3. **Set** start lever to “START” position.



4. **Pull**  until engine starts.



5. **Squeeze**  throttle lock and trigger.

Note: Squeezing & releasing throttle trigger moves start lever to RUN position.

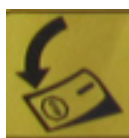

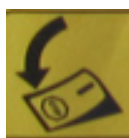
6. **Stop:** Press & Hold  until engine stops.

Checklist for Sub-Contractors

Task	Done
Mondays	
1. Sweep fallen leaves in dog spa.	
2. Water 5 plants with bucket under sink	
3. Visit office and ask: "Are there any special requests this week?"	
4. Check all covered planters (P3, Mac 1-3, Laurier x2) and hand water where necessary	
Daily	
1. Garbage from all beds and lawns & Pull large weeds from lawns (especially at 4 corners and around entrance areas) – 1 hour	
2. Clean front of Laurier (lawn & beds) – 30 mins	
3. Rake lawns (focus on high traffic zones) – 1 or 2 hours	
4. Clean beds as needed	
Special Projects	
Above Freezing Conditions	
1. Dig up yarrow in #16, transplant to berm under Douglas overhang. Spread out soil amender and clean bed as best as possible. Transplant 3 peonies from #27, next to existing peony in #16.	
2. Pull ivy and lady's mantle from #29. Turn soil over.	
3. Pull Shasta daisies from East end of #11.	
4. Continue pulling lady's mantle from #14.	
Below Freezing Conditions	
1. Clean behind Beach Ave hedges – especially blackberries.	
2. Study new garden manual – find some place warm and read it. Please make notes on your copy to help improve it.	
Any Weather Conditions	
1. Remove marked shrubs from #2 & 31	
2. Lawn edging on beds #1, 12, 20, 21, 22, 23	

Plant Reference Guide

List of Perennials

Perennial Name	Bed	Specs
(1) Allium (drumstick) (2) Allium (purple sensation) (3) Allium (azureum)	8, 11, 24, 25	<ul style="list-style-type: none"> ▪ Sun to shade ▪ Regular watering ▪ H:24" (1) ▪ Flower: late spring ▪ H:36" (2) ▪ Flower: summer ▪ H: 24" (3) ▪ Flower: summer
Anemone (Japanese)	Planter A, B, C	<ul style="list-style-type: none"> ▪ Sun to part shade ▪ Keep well-watered ▪ H:4' ▪ W:3'
Anemone (hybrid)	12	<ul style="list-style-type: none"> ▪ Sun to part shade ▪ W:8—48" ▪ H:12-24" ▪ Keep well watered
Ajuga (Bugle) (groundcover)	29, 31	<ul style="list-style-type: none"> ▪ Sun to part shade ▪ H:6" ▪ W:8-14" ▪ Keep well watered
Astilbe	12	<ul style="list-style-type: none"> ▪ Sun to shade ▪ Water regularly, not excessively ▪ H:32" ▪ W:28-24"
Aster	Mac A,B,C, q, r	<ul style="list-style-type: none"> ▪ Sun to part shade ▪ H: 18-24" ▪ W: 12" ▪ Keep soil evenly moist
Aucuba		<ul style="list-style-type: none"> ▪ Sun to shade ▪ Varies in size ▪ Water regulary
Balloon Flower	11	<ul style="list-style-type: none"> ▪ Sun to part shade ▪ H:6-8" ▪ W:12" ▪ Keep well-watered
Bamboo (Heavenly)		<ul style="list-style-type: none"> ▪ Full sun ▪ H:6' ▪ W:3-4'

Perennial Name	Bed	Specs
		<ul style="list-style-type: none"> Keep well-watered
Banana Tree	28	<ul style="list-style-type: none"> Sun Moderately moist Trim down to ground and mulch (add plastic cover to protect from cold)
<i>Bergenia cordifolia</i> (Saxifraga)	13	<ul style="list-style-type: none"> Sun to part shade H:12-15" W:12" Like humus-rich, well-drained soil
Black-eyed Susan (aka <i>Rudbeckia</i>)	14 (oval)	<ul style="list-style-type: none"> Sun to part shade Keep well-watered H:18-30" W:24"
Blueberry <i>Vaccinium Chippewa</i> / Polaris / North Country	15	<ul style="list-style-type: none"> 3-6 hrs morning or late afternoon sun H: 2-5' W:2-5' Water regularly but not excessively Slow release feed in spring
Brunnera (see jack frost)	8	<ul style="list-style-type: none">
Cana Lillies	5, 25	<ul style="list-style-type: none"> Sun to part shade H:4-5' W:6" Water moderately Winter over bulbs in ground if good drainage and no frost (mulch may help)
Catmint	26	<ul style="list-style-type: none"> Sun to part shade H: 18-24" W: 18-24" Allow soil to dry betwn waterings Bloom: late spring tofall
Coneflower (aka <i>Echinacea purpurea</i>)	12 (cardero),14	<ul style="list-style-type: none"> Full sun Allow soil to dry between thorough watering H:15-17" W:12"
Creeping Phlox (see phlox)		<ul style="list-style-type: none">

Perennial Name	Bed	Specs
Crococsmia Hybrid (aka George Davidson Yellow)	26	<ul style="list-style-type: none"> ▪ Sun to part shade ▪ H: 24-30" ▪ W: 12-18" ▪ Keep well-watered
Crococsmia Hybrid (aka Emily McKenzie)	23	<ul style="list-style-type: none"> ▪ Sun to part shade ▪ H: 24" ▪ W: 12-18" ▪ Keep well-watered
Crococsmia Lucifer	Various P3 planters	<ul style="list-style-type: none"> ▪ Sun to part shade ▪ H: 24-30" ▪ W: 12-18" ▪ Keep well-watered ▪ Trim back late fall
Dahlia (Bronzeleaf Novelty-bishop of York)	10, 12	<ul style="list-style-type: none"> ▪ Full sun ▪ H:36" ▪ W:12" ▪ Dig & store bulbs
Delphinium	12	<ul style="list-style-type: none"> ▪ 6+ hrs sun ▪ H: 3-4' ▪ W: 12-18" ▪ Keep well-watered
Dianthus (early bird)		<ul style="list-style-type: none"> ▪ Full sun ▪ H:4' ▪ W: 8" ▪ Well-drained soil
Dianthus Deltoides (maiden pink)	4, 5, 6, 12, 16	<ul style="list-style-type: none"> ▪ Sun ▪ Well-drained soil ▪ H:6" ▪ W:8-12" ▪ Deadhead ▪ Amend with small amounts of lime
Dianthus hybrid (cottage pink)		<ul style="list-style-type: none"> ▪ Full sun ▪ H:6" ▪ W:6-8" ▪ Allow soil to dry betwn waterings
Dianthus (Frosty Fire)	12, 30	<ul style="list-style-type: none"> ▪ 6+ hrs direct sun ▪ H: 6" ▪ W: 9" ▪ Let soil dry out betwn waterings
Euphorbia (aka Tasmanian Tiger)	7, 8, 11, 12, 26	<ul style="list-style-type: none"> ▪ Full sun ▪ H:36" ▪ W:18-24" ▪ Allow soil to dry between

Perennial Name	Bed	Specs
		waterings
Fatshedera lizei (Aureo Maculata) (type of ively)	30	<ul style="list-style-type: none"> ▪ Full sun ▪ H: 1.2-2m ▪ W: 3m ▪ Water liberally ▪ Cut to ground in spring
Foxglove	12 (behind rhodo near Harwood)	<ul style="list-style-type: none"> ▪
Gayfeather (<i>aka liatris spicata</i>)	12, 14, 16, 17, 20, 31	<ul style="list-style-type: none"> ▪ Full sun ▪ Keep well-watered ▪ H:16-20" ▪ W:18" ▪ Bloom late summer to autumn
Goldfinger (<i>aka potentilla fruticosa</i>)	8, 13	<ul style="list-style-type: none"> ▪ Full sun ▪ H:90cm ▪ W:1.25m
Grass (yellow-eyed)	6 or 20	<ul style="list-style-type: none"> ▪ Full sun ▪ H: 8" ▪ W: 10-12" ▪ Prefers moist, well-drained soil
Gaura (Passionate Rainbow)	12 (blooms mid-summer to fall)	<ul style="list-style-type: none"> ▪ Full sun ▪ H: 18" ▪ W: 18-20" ▪ Allow soil to dry betwn waterings
Heather	4, 5, 9, 10, 12, 17, 20	<ul style="list-style-type: none"> ▪
Hebe (Blue Eyes)	13	<ul style="list-style-type: none"> ▪ Full to part sun ▪ H: 6-9" ▪ W: 12" ▪ Water regularly until established. Can handle drought ▪ Fertilize in spring before new growth
Hebe (Red edge)	1, 11, 26, window boxes at Laurier	<ul style="list-style-type: none"> ▪ Full to part sun ▪ H:6-9" ▪ W:12" ▪ Water regularly until established. Can handle drought. ▪ Fertilize in spring before new growth
Hellebore	8	<ul style="list-style-type: none"> ▪ Shade ▪ H:12"

Perennial Name	Bed	Specs
		<ul style="list-style-type: none"> W:12-15"
Heuchera (aka <i>coral bells</i>)	1, 8 30	<ul style="list-style-type: none"> Full to part sun H:10-16" W:12-18" Likes fertile, humus rich, well-drained soil
Hosta	7, 23	<ul style="list-style-type: none">
Hyacinth	11, Laurier Planters (spring)	<ul style="list-style-type: none"> Sun to partial shade Add top dressing of peat & bone meal H: 10" Water thoroughly. Don't dry out completely. Flowering: mid-spring
Hydrangea paniculata (Grandiflora)	13, 15	<ul style="list-style-type: none"> Sun to part shade H:8-12' W:6-10' Keep well-watered
Ice Plant	5 (between chimneys), 6	<ul style="list-style-type: none"> Sun Gritty, well-drained soil H:6" W:12-15"
Iris (<i>pallida</i>)	5, 8	<ul style="list-style-type: none"> Sun to part shade H: 24-30" W: 18" Keep well-watered
Iris (large purple)	P3 planters A, B, E, F, H, I, K, L	<ul style="list-style-type: none">
Ivey (see Fatshedera)	30	<ul style="list-style-type: none">
Jack Frost (<i>Brunnera</i>)	TBA (front of Mac 8??)	<ul style="list-style-type: none"> Part or full shade Moderate watering
Jacob's Ladder (Heavenly Habit)	1	<ul style="list-style-type: none"> Sun to part shade H: 12" W: 12-15" Keep well-watered
Japanese Blood Grass	30?dead?	<ul style="list-style-type: none"> 3-6 hours sun H:18" W:15" Water when top 1" soil dry

Perennial Name	Bed	Specs
Jasmine	P3 Planters D, K, O – (to confirm other planters)	<ul style="list-style-type: none"> ▪ Sun part shade ▪ Water regularly
Lavandula (silver anouk) (hardier than other forms of Lavender)	12, 30	<ul style="list-style-type: none"> ▪ Full sun ▪ W:14" ▪ H: 18" ▪ Keep semi-moist ▪
Lavender	17, 20, 9, 10	<ul style="list-style-type: none"> ▪ Sun part shade ▪ H: ▪ W: ▪ Keep soil moist-ish ▪
		<ul style="list-style-type: none"> ▪
Ligularia (<i>large leaf</i>)	12, 14 (oval)	<ul style="list-style-type: none"> ▪ Sun part shade ▪ H: 4' ▪ W: 3' ▪ Keep well-watered ▪ Prefers humus-rich soil
Lobelia (<i>aka red Queen Victoria</i>)	14 (oval), N	<ul style="list-style-type: none"> ▪ Sun to part shade ▪ H:24-36" ▪ W:12" ▪ Keep well-watered ▪ Bloom-late summer to autumn
Lysimachia (<i>aka Golden Creeping Jenny</i>)	9, 26	<ul style="list-style-type: none"> ▪ Part shade ▪ Water when 1" top dry ▪ H:2" ▪ W:12-24"
Lithodora	13, 25 (around weeping pussy willow)	<ul style="list-style-type: none"> ▪ Full sun ▪ Let soil dry before watering ▪ H: 4-6" ▪ W: 24" ▪ Prune back flowering shoots
Lungwort	7, 10, 12	<ul style="list-style-type: none"> ▪ Part shade to shade ▪ H:9" ▪ W:20" ▪ Keep well-watered ▪ Low, purple flowers, variegated leaves
Lupine	10, 11	<ul style="list-style-type: none"> ▪
Moonbeam (<i>aka Coreopsis verticillata</i>)	2, 13	<ul style="list-style-type: none"> ▪ Sun to part shade ▪ H:18"

Perennial Name	Bed	Specs
		<ul style="list-style-type: none"> ▪ W:18" ▪ Allow soil to dry betwn watering
Myosotis		<ul style="list-style-type: none"> ▪ Part shade ▪ Water when soil dry ▪ H:6" ▪ W:12"
Philodendron	30, Planter F?	<ul style="list-style-type: none"> ▪
Phlox (creeping)	6, 24	<ul style="list-style-type: none"> ▪ 3-6 hrs sun ▪ Allow soil to dry before watering ▪ H: 4-6" ▪ W: 12"
Pink Princess Escallonia	11	<ul style="list-style-type: none"> ▪ Full to partial sun ▪ H:5-6' ▪ W:5-6' ▪ Water regularly (weekly) to establish roots ▪ Feed w/general purpose fertilizer before new growth in spring
Primula (<i>aka Primrose</i>)	1, 4, 5, 6, 8, 11, 15, 16, 17, 20, 21, 22, 23	<ul style="list-style-type: none"> ▪ Sun ▪ Water when 1" top soil dry
Ranunculus	8	<ul style="list-style-type: none"> ▪ 6+ hrs direct sun ▪ Let soil dry between waterings ▪ H: 8-18" ▪ W: 8-12"
Rock Cress (<i>pink small flowers</i>)	25	<ul style="list-style-type: none"> ▪ Sun ▪ Water when soil dry ▪ H:6" ▪ W:10"
Rosemary	P3 planter G?	<ul style="list-style-type: none"> ▪ Sun ▪ Allow soil to dry between waterings ▪ Trim around edges and take off 6" from top – trim back up to 1/3 of plant if needed
Salvia (Garden Sage)	1	<ul style="list-style-type: none"> ▪ Sun to part shade ▪ H: 18" ▪ W: 15-18" ▪ Allow soil to dry between waterings
Sea Thrift	24	<ul style="list-style-type: none"> ▪ Full sun ▪ H: 8" ▪ W: 12"

Perennial Name	Bed	Specs
		<ul style="list-style-type: none"> Allow soil to dry btwn waterings
Silver Nettle (<i>pewter makings with pink spring blooms</i>)s	11, 15, 22	<ul style="list-style-type: none"> Shade Needs ample water H:6" W:10"
Skimmia (Japonica)	22,	<ul style="list-style-type: none"> H:3' W: 3' Sun Moderate water
Sarcococca (<i>aka Himalayan Sweetbox</i>)	P3 planters, et al	<ul style="list-style-type: none">
Snapdragons	1, 7, 11, 13, (border), 15, 24, Douglas Planters (P, Q, R)	<ul style="list-style-type: none"> Sun? Trim back 3" when hard balls with hairs form In cool weather, trim to 4" height (helps new growth & allows blooms to last longer) Trim tall plants to ½ size
Speedwell	2	<ul style="list-style-type: none"> Sun to part shade H: 3-5" W:12" Allow soil to dry between waterings
Spiraea (Flaming Mound)	2, 29, various P3 planters	<ul style="list-style-type: none"> H: 1.5-2m W:1.5-2m Full sun
Stonecrop (<i>aka Sedum</i>)	Douglas Planters (P, Q, R) 11, 12	<ul style="list-style-type: none"> Full sun H:3-6" W:24" Allow soil to dry between waterings
Thyme (red wild)	24	<ul style="list-style-type: none"> Full sun H:6-10" W:12-18" Allow soil to dry between waterings
Thyme (silver posie)	Mac 2	<ul style="list-style-type: none"> Full sun H: 6-12" W: 9-12" Allow soil to dry btwn waterings
Verbena (<i>aka Lascaer red</i>) (tender perennial)	8?, 29	<ul style="list-style-type: none"> Full sun H:4"

Perennial Name	Bed	Specs
		<ul style="list-style-type: none"> ▪ W:12" ▪ Water when top 1" of soil is dry
Willow (<i>Hakuro Nishiki</i>)	10a	<ul style="list-style-type: none"> ▪ Full sun ▪ H: 8-30" ▪ W: 8-30" ▪ Water regularly until established ▪ Slow release feed in spring
Wisteria (Sinensis prolific) (<i>Chinese Wisteria – blue</i>)	28 fence	<ul style="list-style-type: none"> ▪ Partial to full sun ▪ Regular watering
Wormwood (<i>aka Artemesia</i>)	12	<ul style="list-style-type: none"> ▪ Sun part shade ▪ H: 15-18" ▪ W:>24" ▪ Moderate watering ▪ Trim in Spring to 2" after 1st year of growth before active growth begins (2012) ▪ Subsequent years – trim anytime when unruly (remove up to ½ of plant) ▪ Mulch around base with leaves 2 to 3 weeks before frost ▪ Divide plant in fall if woody in center
Zagreb (<i>aka Coreopsis verticillata</i>)	2, 8, 15	<ul style="list-style-type: none"> ▪ 3-6 hours Sun ▪ H: 12" ▪ W: 12" ▪ Let soil dry between watering ▪ Blooms early summer to late fall

List of Annuals

Annual Name	Bed	Specs
Aubrieta (red cascade)	20, round planters	<ul style="list-style-type: none"> ▪ H:4-6" ▪ W:18" ▪ Well-drained, slightly alkaline soil
Bacopa	8, 9, 29 (eye?)	<ul style="list-style-type: none"> ▪ Sun to part shade ▪ H:2-3' ▪ W:8-12" ▪ Protect from frost ▪ Keep soil evenly moist ▪ Use mild liquid fertilizer every 2 wks
Begonia (Rieger)	2, 7, 23, 27 (ramp)	<ul style="list-style-type: none"> ▪ Place in bright environment (avoid direct sunlight) ▪ Water moderately ▪ Fertilize every 2-3 weeks ▪ Pinch off faded flowers ▪ Thrives in temps of 18-25E C
Cala Lily	8	<ul style="list-style-type: none"> ▪ Full sun ▪ Fertilize with slow release fertilizer
Calibrachoa (Aloha Canary Yellow)	26	<ul style="list-style-type: none"> ▪ Full sun ▪ H: 6" ▪ W: 12" ▪ Keep soil evenly moist
Coleus	8, 12, 23,	<ul style="list-style-type: none"> ▪ Shade ▪ H:18-22" ▪ W:12" ▪ Keep soil evenly moist
Dahlia (Arabian Night)	20	<ul style="list-style-type: none"> ▪ Sun to part shade ▪ H:36-48" ▪ W:18-24" ▪ Allow to dry betwn waterings
Fuschia	2 (along high wall Harwood)	<ul style="list-style-type: none"> ▪ Part shade ▪ H: 12-18" ▪ W:12" ▪ Keep soil evenly moist ▪ Use mild liquid fertilizer every 2 wks
Geranium (regal)	22	<ul style="list-style-type: none"> ▪ Sun to part shade ▪ H:18" ▪ W:12" ▪ Keep soil evenly moist

Annual Name	Bed	Specs
Geraniums (royal white)	24, Laurier boxes	<ul style="list-style-type: none"> ▪ Sun ▪ H:15-18" ▪ Water well
Geraniums (Seed) (Pelagonium x hororum)	24	<ul style="list-style-type: none"> ▪ sun part shade ▪ H: 10"-18" ▪ W:9'12" ▪ Keep evenly moist in well-drained soil
Geraniums (pelargonium x hortorum)	1, 20, round planters	<ul style="list-style-type: none"> ▪ Sun part shade ▪ H:12-18" ▪ W:9-12" ▪ Water when top 1" soil dry
Impatiens (cherry splash)	6, 26	<ul style="list-style-type: none"> ▪ shade/part sun ▪ H:10" ▪ W:9" ▪ Keep evenly watered
Impatiens (double)	8, 12, 23	<ul style="list-style-type: none"> ▪ Shade ▪ H: 10-16" ▪ W: 10-12" ▪ Keep soil evenly moist
Impatiens (New Guinea)	8, 23	<ul style="list-style-type: none"> ▪ part shade ▪ H:6-12" ▪ W:12-15" ▪ Keep soil evenly moist ▪
Lobelia (hardy) (upright blue ground cover)	13, 29	<ul style="list-style-type: none"> ▪ sun to part shade ▪ H:8-12" ▪ W:9" ▪ Protect from frost ▪ Keep soil evenly moist ▪ Use mild liquid fertilizer every 2 wks
Nemesia	9	<ul style="list-style-type: none"> ▪ full sun ▪ H:4-12" ▪ W:4-8" ▪ Protect from frost ▪ Keep soil evenly moist ▪ Feed every 2 weeks w/liquid fertilizer

Annual Name	Bed	Specs
Osteopermum (purple daisy-like)	1	<ul style="list-style-type: none"> ▪ Full sun ▪ H:6-18" ▪ W:12-18" ▪ Protect from frost ▪ Allow soil to dry between waterings ▪ Apply balanced liquid fertilizer monthly
Petunia	9, 10 (do well here), 12, 17 Macdonald planters	<ul style="list-style-type: none"> ▪ sun ▪ watch for aphids ▪ moderate watering
Potato vine	Mac 1, 2, 3	<ul style="list-style-type: none"> ▪ sun to part shade ▪ H:24-36" ▪ moderate watering + ▪ thrives in warm weather
Rosmarinus (wilma's gold)	11	<ul style="list-style-type: none"> ▪ part shade ▪ H: 35cm ▪ Semi-moist
Salpiglossis	1, 25	<ul style="list-style-type: none"> ▪ Sun to part shade ▪ H:15-20" ▪ W:10" ▪ Protect from frost ▪ Keep soil evenly moist ▪ Feed every 2 weeks with mild liquid fertilizer

List of Conifers

Conifer Name	Bed	Specs
Pine		▪
Tsatsumi Gold (golden yellow conifer with twisted branches)	29	<ul style="list-style-type: none"> ▪ Full sun ▪ H: 90cm (3')

List of Trees and Bushes

Conifer Name	Bed	Specs
Fig (may 2012)	25	<ul style="list-style-type: none"> ▪ Full to ½ day sun ▪ H: 8-10' ▪ Well-drained soil ▪ Prune to vase shape with a single trunk. Head back or remove tall, vigorous shoots. ▪ Fruit after 1-2 years
Olive (Arbequina) may 2012)	25	<ul style="list-style-type: none"> ▪ Full to ½ day sun ▪ H: 8-10' ▪ Well-drained soil ▪ Head back central leader to form compact, rounded shape. ▪ Fruit after 1-2 years
PawPaw (banana-like flavour fruit and custard-like texture) (may 2012)	25 (need at least 2 plants for cross-pollination)	<ul style="list-style-type: none"> ▪ Full to ½ day sun ▪ H:12-15' ▪ Well-drained soil ▪ Little pruning – fertilize annually in spring ▪ Fruit after 3-5 years
Smokebush (fustet commun) (july 2012)	2	<ul style="list-style-type: none"> ▪ 6+ hrs sun ▪ H:10-15' ▪ W:10-15' ▪ Water regularly until established

List of Perennial Spring Bulbs

Perennial Bulb	Location	Blooms	Specs	Date Planted
Gladiolas (red (r) & orange (o))	P3 – c (r), d (o), e (r), f (o), h, (r), j (o), k (r), m (o), n (r)	Mid-summer	<ul style="list-style-type: none"> ▪ H: 48" ▪ Full sun 	Feb/12
Hollyhocks	12 (in front of pyracanthas)	Mid-summer	<ul style="list-style-type: none"> ▪ H: 72" ▪ Full sun 	Feb/12
Liatris (spicata) (gay feather)	12, 16, 20			April/11
Dahlia (le baron pink) (full sun)	12	Summer/fall		April/11
Dahlia (orion- white/pink outline)	12			April/11

Watering Procedures

Upper Beds – once a week or as needed (check if dry 2 inches below surface of soil)

Beds **2, 6, 7, 8 and 11** – requires manual watering (turn valve west of Garden room around corner). Turn valve counterclockwise quarter turn.

P3 Planters

- require watering during winter months. Follow manual watering procedures.
- once a week starting in spring (Feb?) and possibly twice a week (if very dry summer) [See P3 Planters Table](#).

Laurier Boxes (2) - requires manual watering procedure during dry weather.

Douglas Planters (3) – requires manual watering procedure during dry time.

Mac 1, 2 & 3 Planters – requires manual watering procedure during dry time. Center planter requires all year watering.

P3, Oval 14, Mac 1, 2, & 3, Round Planters 1 & 2, Laurier Planters

Watering Method	Waters	Plants in Beds
WTap-1A (at Laurier side)	Planter A	Anemone, Jasmine, wild geranium (right corner), Iris (left corner & right corners)
WTap-2B	Planter B	Sarcococa, Nicotiana, Azaleas, Iris (middle)
WTap-3C	Planter C	Nicotiana, Azaleas, wild geraniums, Anemone
WTap-4D	Planter D	Nicotiana, Azaleas, wild geraniums, purple mum
WTap-5E	Planter E	Nicotiana, Azaleas, wild geraniums, Iris (right)
WTap-6F	Planter F	Varigated Shrub (at each end), Wild rose, Jasmine (small), sedum, azalea, Iris (left)
WTap-7G	Planter G	Azaleas, sedum bush rose, jasmine, philodendron
WTap-8H	Planter H	Boxwood, hosta, bush rose, Rosemary, Crocosmia (Lucifer), Iris (left & right)
WTap-9I	Planter I	Geranium phaeum (3), rosemary, nicotiana, hosta, Iris (left & right)

Watering Method	Waters	Plants in Beds
WTap-10J	Planter J	Bush roses, jasmine, sedum, heuchera (red), Iris
WTap-11K	Planter K	Wild rose, Jasmine (small), sedum, azalea, Iris (middle & right)
WTap-12L	Planter L	Ferns, rose, crocosmia (Lucifer), sarcococca, Iris (left)
WTap-13M	Planter M	Lobelia, Ferns, sarcococca, crocosmia (Lucifer)
WTap-14N	Planter N	Bush Rose, ferns, hostas, crocosmia (yellow?)
WTap-15O	Planter O	Bush Rose, hostas, jasmine, sarcococca, Dark purple Iris
Hand Water with bucket or hose	Planter P	Celosia, California Lilac, petunia, snapdragons, stonecrop
Hand Water with bucket or hose	Planter Q	Snapdragons, dianthus, Pieris, petunias, stonecrop, Crocosmia
Hand Water with bucket or hose	Planter R	Snapdragons, Pieris, petunias, stonecrop
Hand water	Laurier Window boxes	Hebe, geraniums
Hand water - Mac 2 (requires more water than other planters) - Water inner/building side more	Mac 1, 2, 3	Sarcococca, Pieris, begonia, celosia, heuchera, potato vine (middle)
Hand Water with bucket or hose	Round Planters 1 & 2	Lavender, geranium, stonecrop, Pieris
Oval 14 (Tap inside parking garage) Right handle & circular valve 2 o'clock (on) 10 o'clock (off)	Planter 14 (oval)	Lobelia (red), gayfeathers, carnations (front) Sedum, begonia (right) Orange poppies, Black-eyed Susan, dianthus (west) Primulas (along rock path) Korean lilac (either side)
Hand water using bucket under sink.	Columbus Dog Room Plants	Mandevilla, Oleander (2), Non-hardy hibiscus (2)